

Product Information Sheet

Live Front Axle with Air Disc Brake Assembly

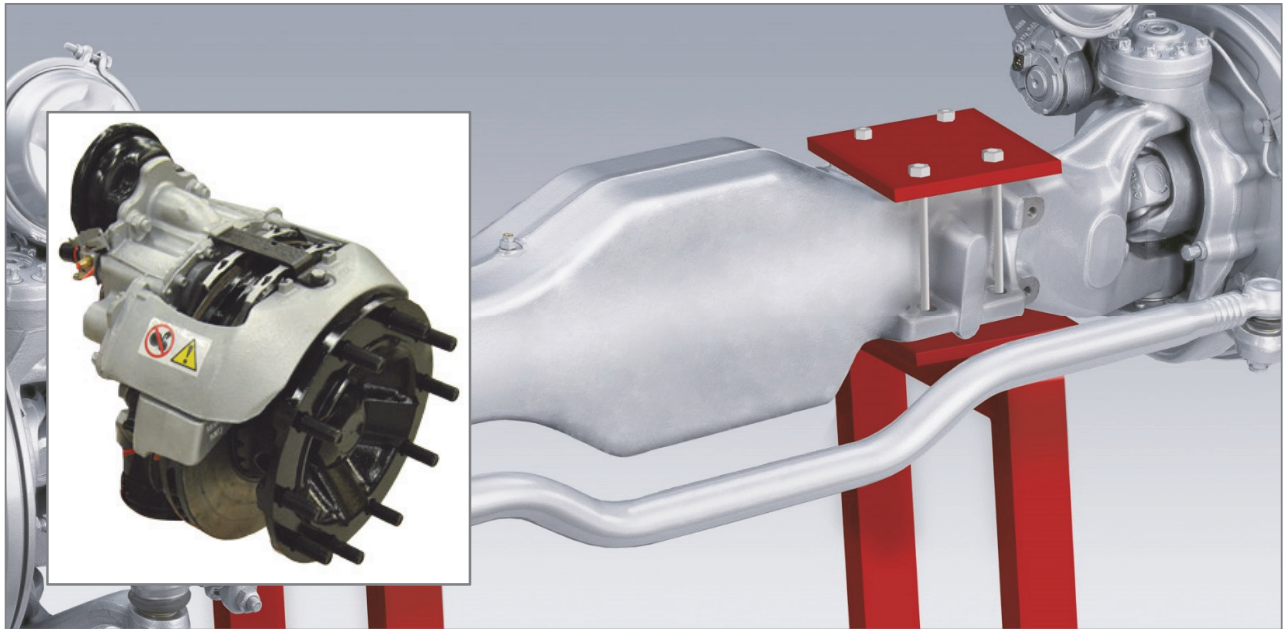

Fully operational heavy vehicle front axle - complete with disc air braking system, using single line air pressure to operate the disc brakes via the foot brake and treadle valve.

Specification

- Operational air brake system with footbrake
- Mounted on a self-contained frame and base plate, complete with casters
- Powder-coated paint finish

Components Include

- Hub assemblies
- Spring brake actuators
- Brake discs
- Callipers
- Treadle valve
- Steering assembly

Items Included:

- Trainer
- Practical activities manual

Other Items Required:

- Automotive workshop tools

General Information:

Trainer Dimensions (W x D x H):
1450 x 2210 x 1150 mm / 57 x 87 x 45 inches

The image shown is for illustrative purposes only – actual product may vary due to product enhancement.

Order Code: 785-01

P9289-B

For more information visit ljcreate.com